

# Nampa Highway District No.1 Official Map



03 N

02 N

01 N

01 S

RANGE 04 W 03 W 02 W 01 W

RANGE 04 W 03 W 02 W 01 W

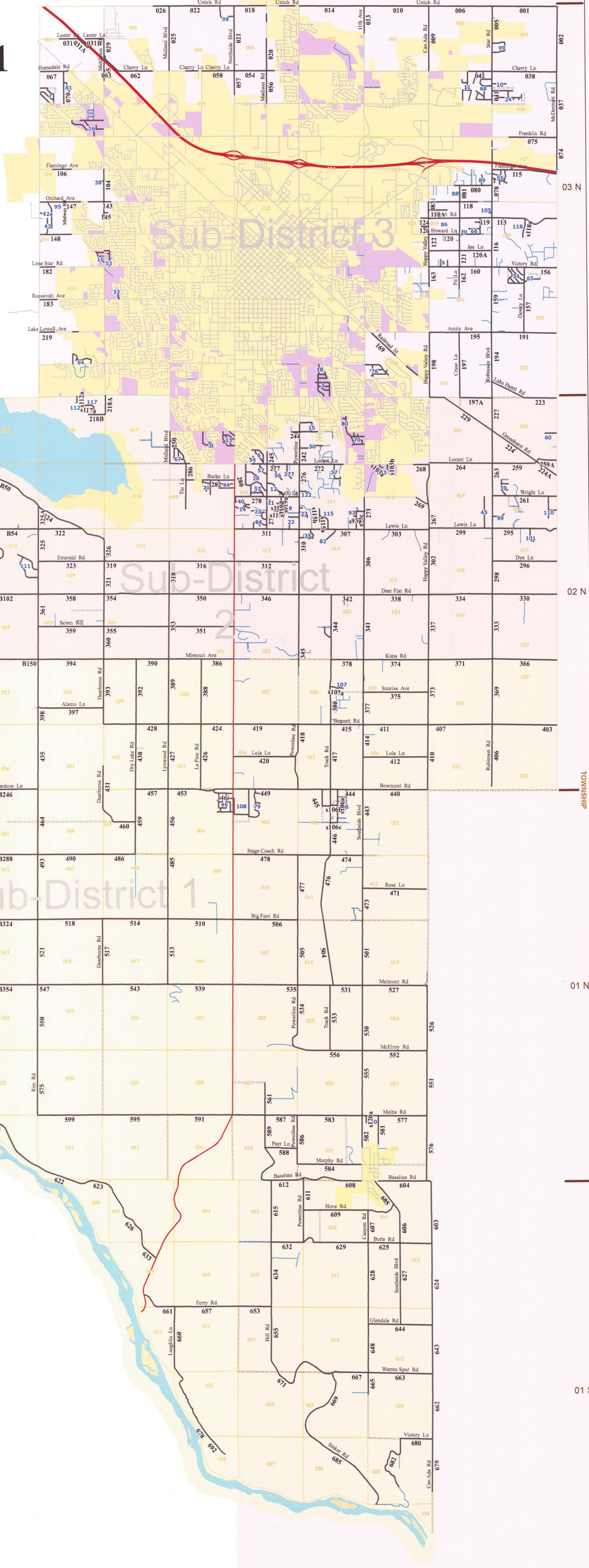

In accordance with Idaho Code 40-202 (Designation of Highways and Public Rights-of-Way) and 40-1310 (Powers and Duties of Highway District Commissioners), this map is hereby adopted as the **Official Map of the Nampa Highway District No. 1** this 10<sup>th</sup> day of January, 2017.

**BOARD OF COMMISSIONERS**

*Dick Smith*  
Dick Smith, Chairman

*Randy Noble*  
Randy Noble, Vice-Chairman

*Bryce D. Millar*  
Bryce D. Millar, Secretary/Treasurer

**Legend**

- Public Highway, under Nampa Highway District No.1 jurisdiction.
  - Public Highway, not under Nampa Highway District No.1 Jurisdiction.
  - Private Roads, not under Nampa Highway District No.1 jurisdiction
  - State Highway, not under Nampa Highway District No.1 jurisdiction
  - Public Right of Way under Nampa Highway District No.1 jurisdiction, but not maintained by Nampa Highway District No.1
  - Nampa Sections
  - Enclaved Areas
  - City Limits
  - Island
  - Lake
  - Lake Overflow
  - River
- Nampa Highway District Sub Districts**
- Sub-District 1
  - Sub-District 2
  - Sub-District 3

1 inch = 4,000 feet

